

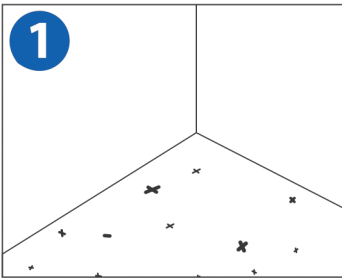

## BLOCK-IT® Floor Underlayment Installation Instructions



### STEP 1

Sweep clean and remove all debris from sub floor.

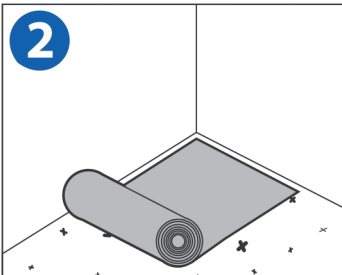

### STEP 2

Run the first sheet of Kimberly-Clark BLOCK-IT® Floor Underlayment along the longest wall in the room positioning the gray textured side facing up. If desired, place only enough staples along the wall to keep Underlayment flat. Staples and/or adhesive strips are not required on concrete sub floors.

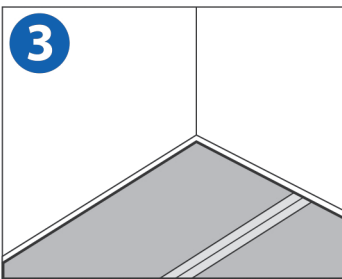

### STEP 3

Lay out each additional row of Kimberly-Clark BLOCK-IT® Floor Underlayment with the additional row edge underneath the previous row seams. Tape is not required on seams, but if desired and/or Underlayment will not be covered by flooring quickly, use an acrylic tape along the row seams of Floor Underlayment to eliminate slipping.

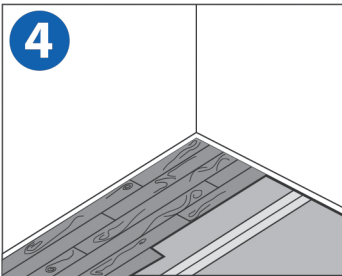

### STEP 4

Lay flooring directly over the top of Kimberly-Clark BLOCK-IT® Floor Underlayment according to flooring manufacturer installation instructions.



## Kimberly-Clark BLOCK-IT\* Floor Underlayment

PHYSICAL PROPERTY	TEST METHOD	TEST RESULTS
<b>Noise Dampening</b> within the room and floors below		
STC	ASTM E 90-04	65 decibels
IIC	ASTM E942-09	71 decibels
Delta IIC	ASTM E 2179-03	19 decibels
<b>Cushioning</b>		3D Textured bond pattern
<b>Moisture Barrier</b> (Hydrohead)	ASTM D-779 Standard Test Method for Water Resistance of Paper; Paperboard, and Other Sheet Materials by the Dry Indicator Method	285 centimeters water gauge
<b>Water Vapor Transmission Rate</b>	ASTM E-96 Standard Test Method for Water Vapor Transmission of Materials	15 perms
<b>Usage</b>	Recommended for all staple and nail down installation of solid and engineered wood floors, laminate or click-together vinyl	